

# STRINGHOLDER AND KNIFE TRAP ASSEMBLY

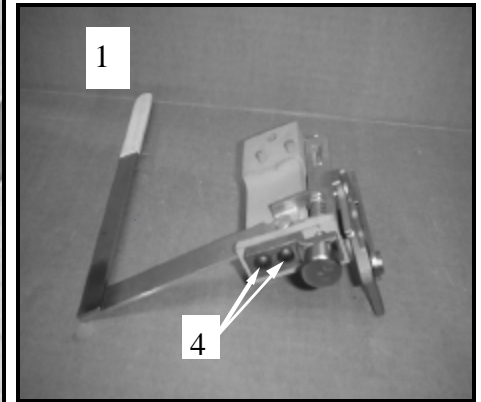
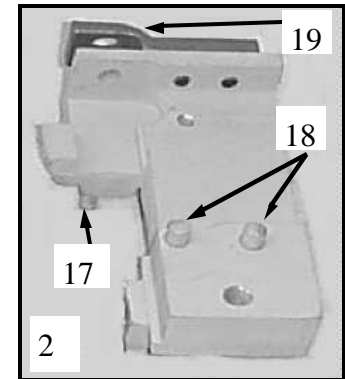
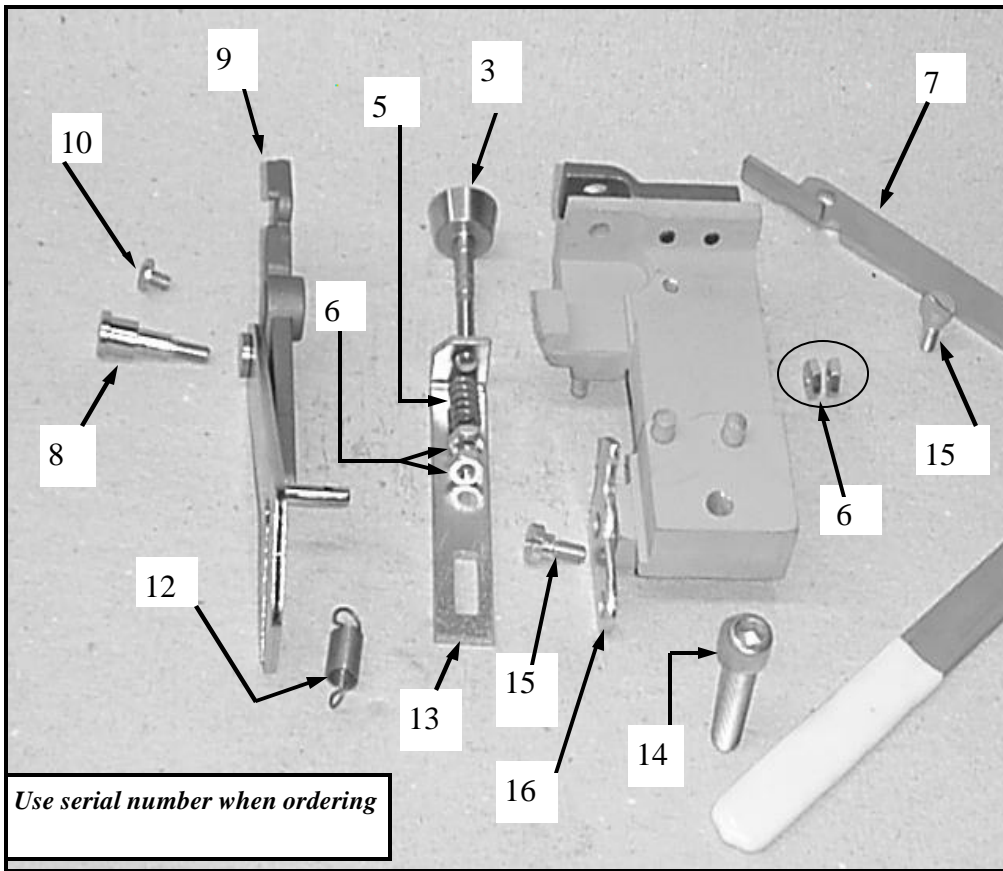

| Index | Part                                      | Qty | Index | Part                                       | Qty |
|-------|---|-----|-------|--|-----|
| 1*    | 030179 Stringholder Assembly              | 1   | 12    | 074011 Spring, Knife Trap                  | 1   |
| 2**   | 030142 Stringholder and Pins Sub Assembly | 1   | 13    | 030084 Lever, Slide                        | 1   |
| 3     | 030147 Button, Stringholder               | 1   | 14*** | 100565 Screw, Socket Head Cap              | 1   |
| 4     | 100489 Screw, 10-32 (not shown)           | 2   | 15    | 100088 Screw, Pivot                        | 2   |
| 5     | 074009 Spring, Stringholder button        | 1   | 16    | 030083 Pivot, Dual Tension                 | 1   |
| 6     | 100144 Nut, Hex 10-32                     | 4   | 17    | 100158 Pin, Groove                         | 1   |
| 7     | 032239 Lever, Button Release              | 1   | 18    | 100569 Pin, Groove                         | 2   |
| 8     | 100730 Screw, Knife Trap Pivot            | 1   | 19    | 030164 Face, Heavy Stringholder            | 1   |
| 9     | 032159 Knife Trap & Lever Assembly        | 1   | 20*** | 030031 Angle and Link Assembly (not shown) | 1   |
| 10    | 100090 Screw, Binder Head 8-32 x 1/4      | 1   |       |  |     |
| 11*** | 021009 Package of 10 Knives – (not shown) | 1   |       |  |     |

\* Assembly does not include items 11,14,20 Order Separately

\*\* Includes 4,17,18,19

\*\*\* Sold Separately

Item # 2 and 19 are set for Bunn 16 Ply Twine